



MENS CLINIC PROJECT

14-20
BLACKWOOD ST
NORTH MELBOURNE

MENS CLINIC PROJECT

Welcome to a new era in cancer care for men.

In late 2013, a group of 70 men met for dinner and decided to contribute to what would become the nation's first dedicated facility for men with prostate cancer and related health issues, open for the general public to attend.

It has been a long time coming, too long in fact, for the massive unmet need in cancer support for men to be addressed. With thanks to these community leaders we are now proud to announce the new location of this unique and unrivalled facility.

On behalf of the Australian Prostate Cancer Research Board, we thank you for supporting this initiative. We still have a long way to go; however, your involvement to date has allowed us to begin the journey of achieving better health outcomes for men.

We look forward to officially launching the facility in the coming months and we encourage you to contact us at any time for further information.

Sincerely,



Bill Guest
Clinic Patron



Prof Tony Costello
Head of Department
Royal Melbourne Hospital



Dr. Daniel Moon
Urologist
Royal Melbourne Hospital

BOARD

Chair: Laurence G Cox AO
Dept: Leon L'Huillier
Kevin Luscombe AM

David Shaw
Anthony J Costello
Amanda Milledge

Bill Guest
John Waters

CHIEF EXECUTIVE

James Garland

CLINIC MANAGER

Dr Joseph Pereira

CONTACT US

info@apcr.org.au

Ph: (03) 9421 0985

Mob: 0458 800 111



Australian
Prostate Cancer
Research

MENS CLINIC PROJECT

RECEPTION LOUNGE

The waiting room is a thing of the past at the men's clinic. We are revolutionising healthcare and the reception area will be nothing less than a home away from home for patients and their guests. No drab rows of vinyl classroom chairs or stacks of ancient Women's Weekly magazines. A room for men.

Active, yet relaxing. Comfortable, yet functional. Wi-fi access and amenities to ensure men can check emails, work if they need to and have a seamless service that doesn't disrupt their day. Use a meeting room if you have business to attend to or sharpen your game on the putting green....



MENS
CLINIC
PROJECT



MENS CLINIC PROJECT

LOBBY

Enter a private, discrete foyer off Blackwood St. Straight into the lifts that service only 3 operational floors or access on-site undercover parking to attend your appointment. The clinic makes a point of changing the way men will access services by presenting the facility as professional rather than sterile. Research highlights the many barriers men face in proactively engaging in healthcare and we are ensuring we approach this Australian first with maximum attention to detail to create an appealing space for attendees.

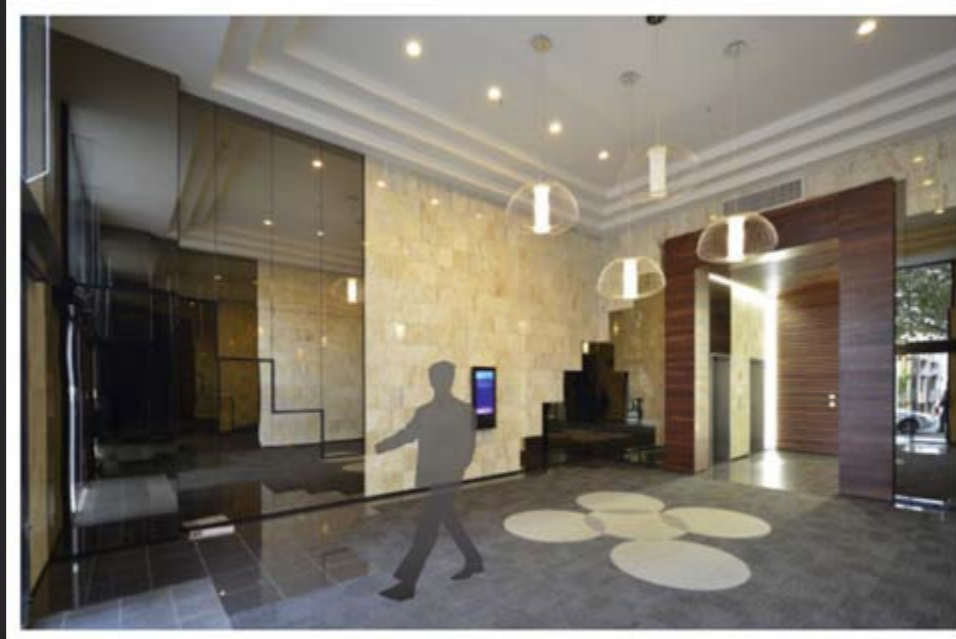

GYM

Every year at our Prostate Cancer World Congress, held here in Melbourne, we learn more about the positive effect of exercise in the prevention and management of prostate cancer. A fully appointed gym with monitoring equipment will allow exercise physiologists and allied health staff to work with patients to improve their physical condition. Individual programs will be tailored for men with prostate cancer and other health issues to ensure all possible treatment support is provided at the clinic. Over time it is envisaged that the clinic will also be able to address, nutrition and cardiovascular focused support for men attending. It goes without saying patients can use the gym before or after consultations if they want to get in a quick workout during the day.



MENS CLINIC PROJECT

CONSULTATION ROOMS

The centre boasts 10 consulting spaces, purpose fitted to address a range of issues, from prostate cancer testing and support to mental health, physiotherapy and more. Clinical specialists from a wide range of disciplines will provide a holistic set of services to ensure that all aspects of man are considered, even down to diet, cholesterol and of course prostate risk and surveillance. It is important that we maintain a strong focus on prostate cancer as the number one killer for men; however, an active, healthy lifestyle both physically and mentally, is one of the best ways to reduce risk in men. Each room also enjoys fantastic views of the Melbourne skyline and landscape.



TISSUE BANK

A state-of-the-art tissue banking and laboratory facility will ensure all tests, samples and biological materials can be preserved and analysed as needed. Emerging technologies now allow us to sequence the human genome and test for irregularities that can predict cancer progression and behaviour. The tissue bank will keep samples frozen for many years and will provide a platform for our researchers to develop new screening tests for prostate cancer and other related conditions. Australian Prostate Cancer Research already partners with the Royal Melbourne Hospital and University of Melbourne in ground-breaking studies in human genomics; the clinic will ensure this research reaches even greater heights. Most importantly, ensuring better tests and treatments for men.



MENS CLINIC PROJECT

With thanks to

Alan Guest
Andrew Burnes
Andrew Cattermole
Andrew Facey
Andrew Hanson
Andrew Perry
Andrew Roberts
Andrew Waddell
Andrew Willder
Anthony Bongiorno
Anthony Burgess
Anthony Shadforth
Antony Lynch
Barry Gilbert
Bill Denton
Bill Guest
Bill Mole
Bruce Parncutt
Channel 9
Charles Farquharson
Chris Chadwick
Clive Bartrouney
Clyde Davenport
Colin DeLutis
Colin Galbraith
Craig Hutchison
Craig Kimberley
Craig Mathieson
Damian Oliver
Damien Marasco
David Hayes
David Hendy
David Thurin
Drew Robinson
Ed Dixon Food

Eddie McGuire
Frank Costa
Frederick Oldfield
Gary Black
Gary Simonds
Geoff Freeman
Gerard Higgins
Glen Bartlett
Glenn Calder
Graham Wheeler
Grant Custance
Greg Campbell
Greg Carns
Harold Mitchell
Jack Bongiorno
James Connell
Joe Connor
John Hatfield
John Higgins
John & Mark Rothfield
John Russell
Keith Harrison
Kim McKendrick
Kon Mantzis
Konfir Kabo
Laurie Heale
Leon L'Huillier
Lisa Bond
M&C Saatchi
Mark Granter
Mark Healy
Mark Laidlaw
Mary & Fred Schepisi
Members of the Large
Format Retail Association

mateswithcancer group
Metricon Homes Pty Ltd
Michael Gannon
Michael Robertson
Michael Wilton
Mike Brady
Mike Gibson
Nick Williams
Peter Ingham
Peter Mann
Peter Robertson
Peter Robinson
Peter Spargo
Peter Thomas
Phillip Prendergast
Pierre Bernardi
Portland House Fdn
Raamy Shahien
Robert Flower
Robert Officer
Sam Bashiry
Simon Parsons
Stephen Bickford
Stephen Mandie
Sticky Vinyl
The Hon Josh Frydenberg
The Hon Peter Dutton
The Myer Foundation
The Pratt Foundation
Tim Roberts-Thomson
Timothy Margetts
Vin Sammartino
Warwick Fabrics
Westpac Group

With thanks also to those who have donated recently.
Please advise if you have not been included.

MENS CLINIC PROJECT



**MENS
CLINIC
PROJECT**

14-20

**BLACKWOOD ST
NORTH MELBOURNE**